

## RK, RKT and RKPK Disc valves

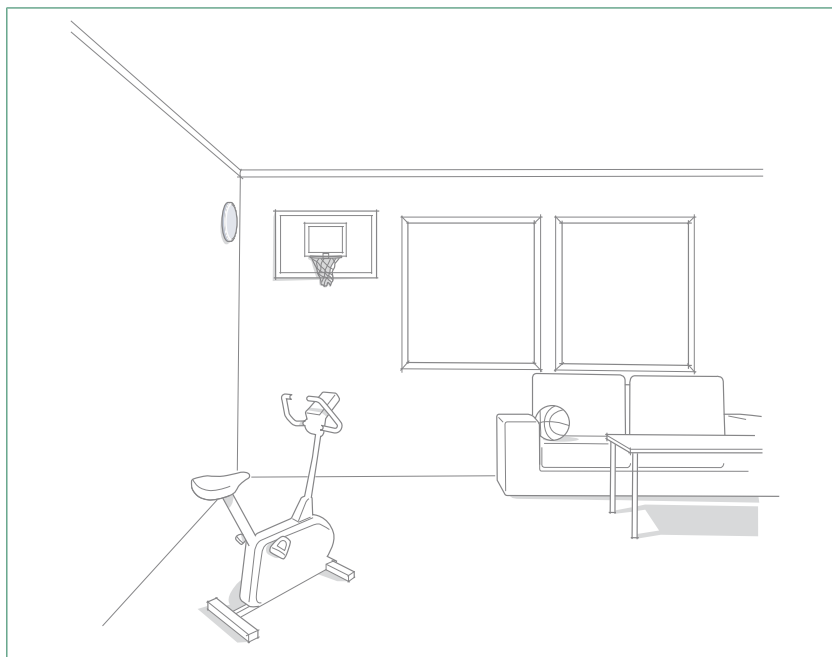

RK, RKT and RKPK are designed for natural exhaust ventilation. They can also be used as supply and fresh air valves.

### Quick Selection

Size	Connection Ø mm	Air flow range l/s when slot 15 mm and pressure drop		
		50 Pa	100 Pa	150 Pa
RK-63	63	12	17	22
RK-80	80	24	33	41
RK-100	100	23	32	41
RK-125	125	38	55	68
RK-160	160	45	62	78
RK-200	200	60	85	100
RK-250	250	60	90	110
RK-315	315	90	130	160

### Specifications

- Easy to install
- Three disc material alternatives: plastic, stove enamelled steel and impregnated common alder.

### Product code example

Disc valve RKT-200

AIRTREND Ltd  
 Predstavništvo u Beogradu  
 Kumanovska 14, 11000 Beograd  
 Tel: 011/3836886, 3085740  
 Faks: 011/3444113  
 e-mail: gobrid@eunet.rs  
 web: www.airtrend.rs

### Selection diagrams

**RK-63**

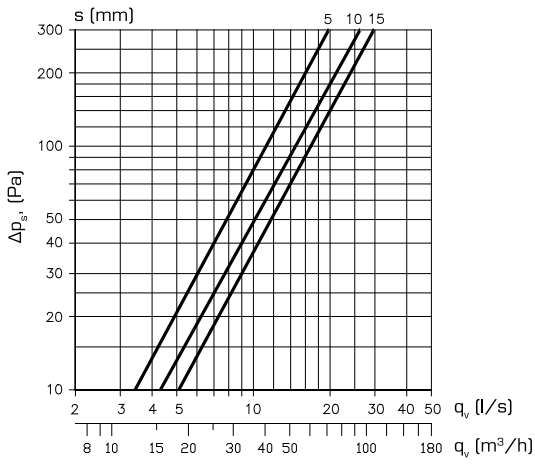

**RK-80**

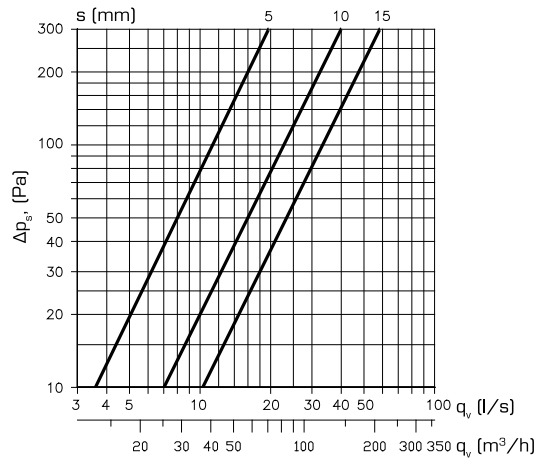

**RK-100**

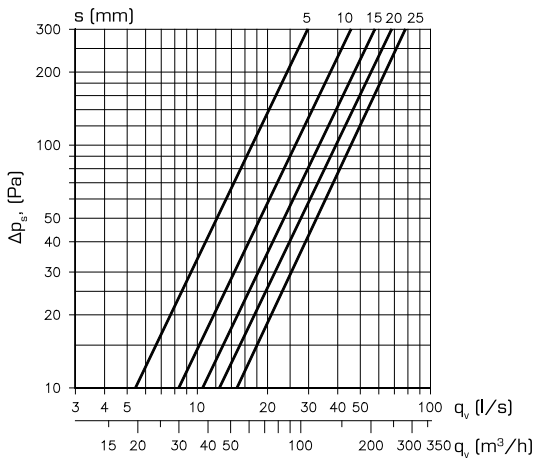

**RK-125**

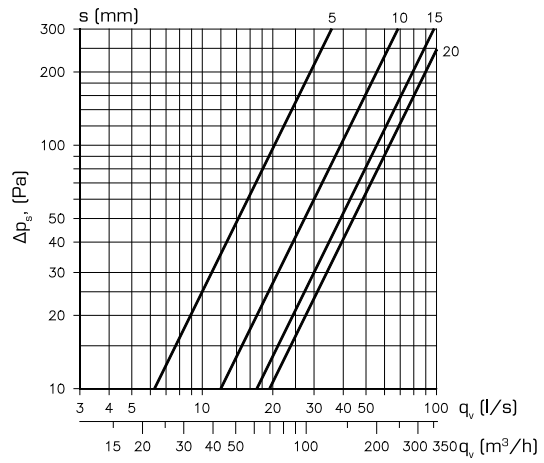

**RK-160**

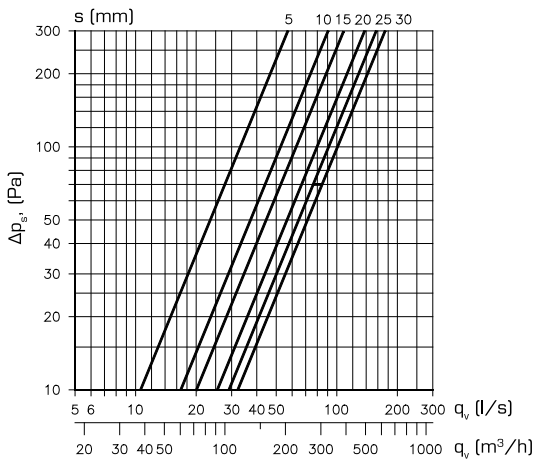

**RK-200**

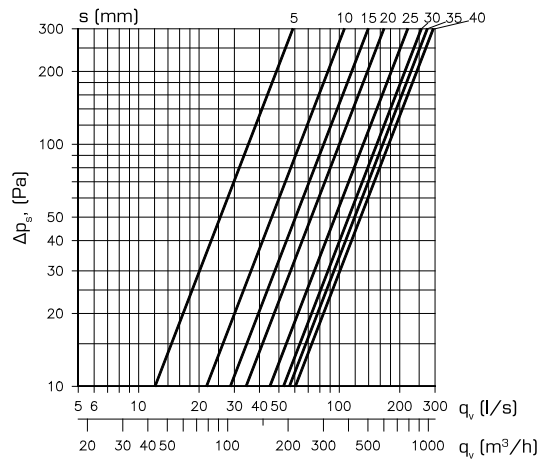

### Selection diagrams

#### RK-250

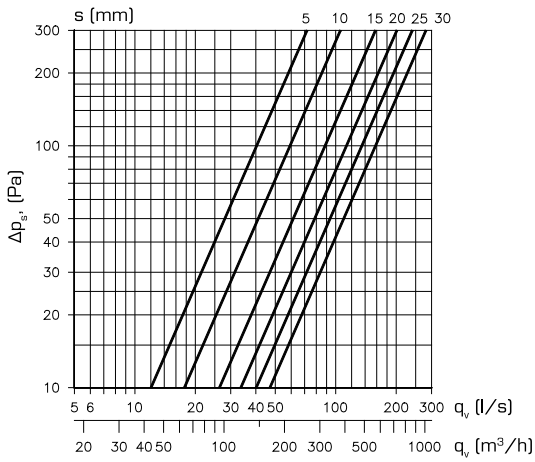

#### RK-315

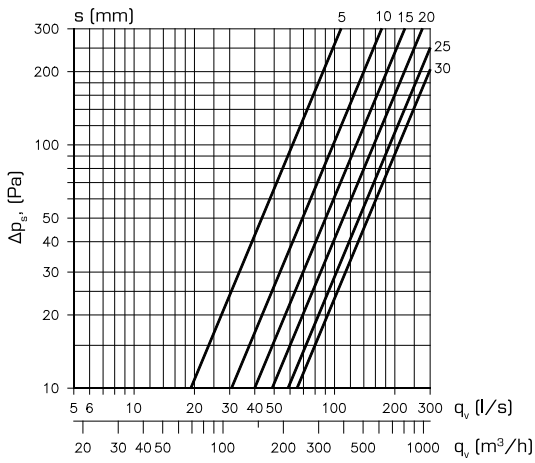

### Dimensions and weights

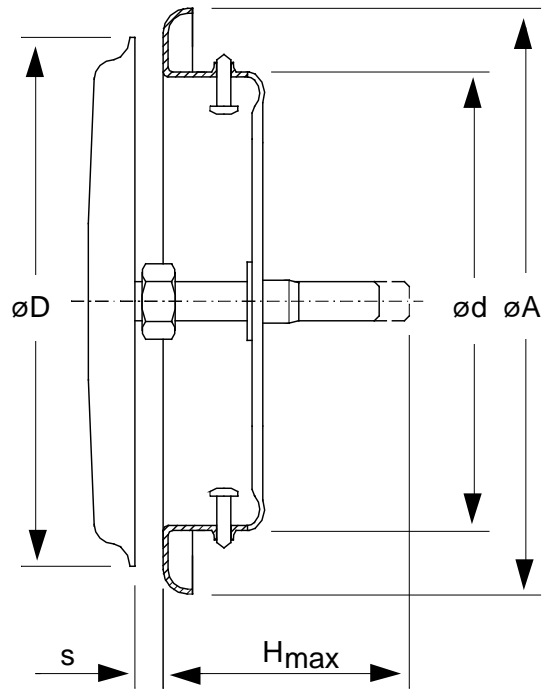

#### RK

Nominal size	$\varnothing D$ [mm]	$\varnothing A$ [mm]	$\varnothing d$ [mm]	$H_{max}$ [mm]	Weight [kg]
063	100	80	57	35	0.11
080	100	100	77	35	0.14
100	125	120	97	45	0.17
125	150	150	122	45	0.24
160	190	190	157	55	0.35
200	230	230	197	55	0.45

#### RPKK

Nominal size	$\varnothing D$ [mm]	$\varnothing A$ [mm]	$\varnothing d$ [mm]	$H_{max}$ [mm]	Weight [kg]
100	125	120	97	45	0.19
125	155	150	122	45	0.26
160	195	190	157	55	0.37

#### RKT

Nominal size	$\varnothing D$ [mm]	$\varnothing A$ [mm]	$\varnothing d$ [mm]	$H_{max}$ [mm]	Weight [kg]
063	90	80	57	35	0.12
080	90	100	77	35	0.16
100	110	120	97	45	0.19
125	140	150	122	45	0.26
160	180	190	157	55	0.37
200	220	230	197	55	0.50
250	275	270	240	65	1.05
315	340	330	301	60	1.53

## Installation, material, application

### Installation

The valve is fixed to a duct by means of two screws (included), turning the screws from the inside of the valve body. Valves of sizes 100 - 200 can be mounted without screws to a covering plate MPL.

### Material

Product	Material		
	Disc	Body	Screw
RK	Plastic	Stove enamelled steel	Zinc-coated steel
RKT	Stove enamelled steel	Stove enamelled steel <sup>1)</sup>	Zinc-coated steel
RKPK	Impregnated common alder	Stove enamelled steel	Zinc-coated steel

<sup>1)</sup> size 250 and 315 -aluminium

### Application

RK is designed for natural exhaust ventilation. It can also be used as a supply and fresh air valve. RK is easy to install and available in three alternative disc materials.

### Descriptive text

Disc valve RK, e.g RKT-315 manufactured by FläktWoods.

## Product code and accessories

### Product code

**Disc valve, plastic** **RK-aaa**

**Size (aaa)**  
63, 80, 100, 125, 160, 200

**Disc valve, stove enamelled steel** **RKT-aaa**

**Size (aaa)**  
63, 80, 100, 125, 160, 200, 250, 315

**Disc valve, impregnated common alder** **RKPK-aaa**

**Size (aaa)**  
100, 125, 160

### Accessories

**Covering plate** **MPL-aaa**

**Size (aaa)**  
100, 125, 160, 200